



**Parts List for 20 GW Unit
Style "IRA Modular input"**

Power Transmission Solutions
Regal Beloit America, Inc.
7120 New Buffington Road
Florence, KY 41042
Application Engineering: 800 626 2093
www.RegalPTS.com

FORM
9445E
Revised
July 2016

⚠ WARNING

- Read and follow all instructions carefully.
- Disconnect and lock-out power before installation and maintenance.
Working on or near energized equipment can result in severe injury or death.
- Do not operate equipment without guards in place. Exposed equipment can result in severe injury or death.

⚠ CAUTION

- Periodic inspections should be performed. Failure to perform proper maintenance can result in premature product failure and personal injury.

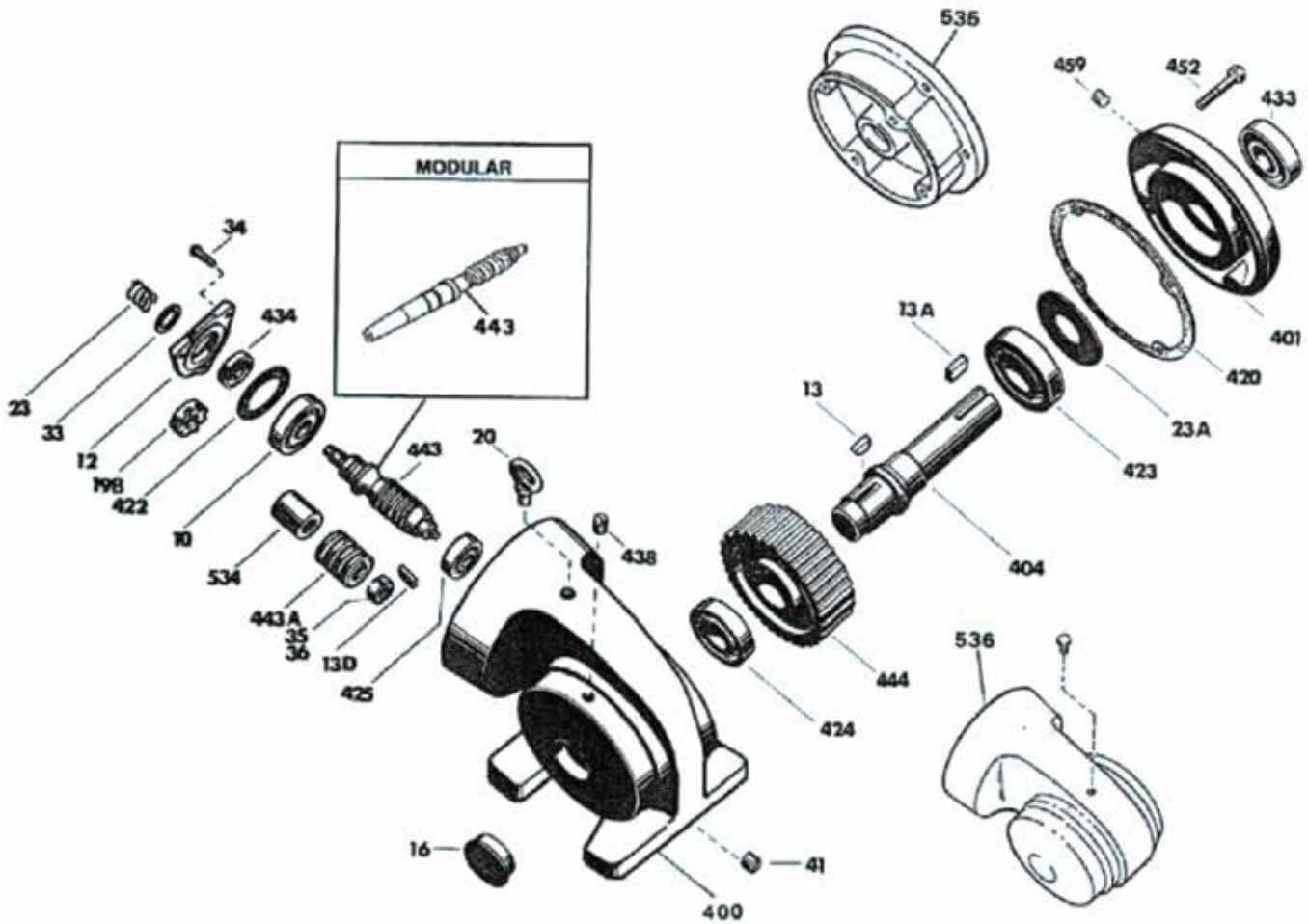

Item No.	Description	Part No.	No. Req'd	Additional Description
10	Bearing (Position No. 7) – Cone – Cup	170562	1	HM89449
		170561	1	HN89410
		168827	3	0.003
		168828	3	0.01
	Shims (Bearing Position 7A)	168829	2	0.025
		151549	1	
		151549	1	
12	Bearing Cap	151549	1	
13	Key	35734	1	3/8 SQ x 2 1/2
13A	Key (Take-off Shaft)	5015	1	3/8 SQ x 2 1/4
16	Bracket Plug	379627	1	
19	N/A			
20	Eyebolt	133167	1	
23	Spring (w/single phase motors)	N/A		
23A	Shims (Bearing Position 1)	168830	As Req'd	0.003
		168831		0.01
		168832		0.025
33	Snap Ring		1	
34	Screw (w/lockwasher on some units)	147434	4	
	(Bearing Cap)			
35/36	Locknut & Lockwasher	N/A	1	
41	Pipe Plug	372832	4	
400	Gear Case	399523	1	
401	Pulley End Bracket	399521	1	
404	Take-off Shaft	380256	1	
420	Gasket (Pulley End Bracket)	166193	1	
422	Gasket	153559	1	
423	Bearing (Position 1)	170564	1	25590
		159946	1	25520
424	Bearing (Position 2)	170564	1	25590
		159946	1	25520
425	Bearing (Position 3)	170562	1	HM89449
		170561	1	HM89410
433	Oil Seal (Pulley End Bracket)	399647	2	472164
434	Oil Seal (Position 7)	216952	2	471268
438	Vent Plug	111045	1	
443	Worm Shaft - 10:1 Ratio	386403	1	
	- 15:1 Ratio	386471		
	- 18:1 Ratio	392131		
	- 20:1 Ratio	386472		
	- 25:1 Ratio	389616		
	- 30:1 Ratio	386473		
	- 40:1 Ratio	386474		
	- 50:1 Ratio	386475		
443A	N/A			
444	Worm Wheel - 10:1 Ratio	359681	1	
	- 15:1 Ratio	359682		
	- 18:1 Ratio	396115		
	- 20:1 Ratio	359683		
	- 25:1 Ratio	387260		
	- 30:1 Ratio	359684		
	- 40:1 Ratio	359685		
	- 50:1 Ratio	380726		
- 60:1 Ratio	359687			
452	Screw (Pulley End Bracket)	5892	6	
459	Pipe Plug (Pulley End Bracket)	372832	2	
534	Worm Spacer	N/A		
535	Flange GWV	N/A		
536	Gear Case GWV	N/A		

